



Upcoming Construction on 208th Ave NE – January 27th to January 31st, 2025

Dear Residents and Commuters,

Please be advised that starting January 27th, 2025, and concluding January 31st, 2025, construction activities will affect 208th Ave NE. During the hours of 7:00 a.m. to 3:30 p.m., Pivetta will be installing a new vault and water main across 208th Ave as part of the Louis Thompson Tightline Project. Flaggers will be stationed along the route to assist with traffic flow, and school buses will be given priority access.

Pivetta is working with the City to develop a traffic control plan (TCP) that allows one lane to be open at all times during construction except for when we are laying pipe across the road and during limited, temporary construction activities. Once the TCP has been agreed to, it can be provided upon request.

While Pivetta will do its best to allow vehicles to pass through, the nature of the work, combined with the size of the equipment and road limitations, may result in wait times of up to 15 minutes. This delay is necessary for Pivetta to safely secure the work zone and ensure both vehicles and pedestrians can pass through safely. To help you plan, we are anticipating the most delays while laying the pipe across 208th on Wednesday, January 29.

The 15-minute wait time will be implemented to maintain safety for residents, drivers, and Pivetta's construction crew. Given the location and scope of the work, it is crucial that pedestrians or vehicles do not attempt to enter the construction area without clearance from Pivetta's traffic control team to avoid potential safety risks. Please drive slowly through the construction area.



1812 Pease Avenue Sumner, WA 98390 | www.pivetta.com | T: 253.862.7890 | F: 253.470.5008

For your safety, we will mark off the construction area with cones and ask that you not walk into any designated construction zones.

Pivetta would like to reassure you that in case of an emergency, we will prioritize allowing emergency vehicles to pass through as soon as it is safe to do so. Emergency access will always be granted promptly. We are also working to avoid disruption to trash collection, which takes place on Tuesdays. Mail services will remain unaffected during the construction period.

The City of Sammamish website will provide ongoing updates of construction and details of the project. The web address for this project is:

www.sammamish.us/LTR

We apologize in advance for the inconveniences this will cause and will work to provide a safe project site for the travelling public, pedestrians, and our workers.

Thank you for your cooperation and patience,

Pivetta Brothers Construction, Inc

208th AVE NE watermain tie in north side

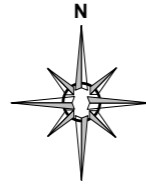

TCP designed by: Katelynne Kauzlarich
 TCS # WA008416
 EXP Date: 3-31-2025
 Phone # 253-670-3141
 Katelynne@pivetta.com
 Date: 01-09-2025

Legend

- Cone
- traffic controller stop
- W20-1 Road Work Ahead
- W20-4 One Lane Road Ahead
- W20-7 Flagger

IF APPLICABLE
 THESE SIGNS SHALL BE DISPLAYED
 DURING NON-WORKING HOURS
 ACCORDING TO RCW 47.36.200

W20-24 W21-1701

SPEED LIMIT 25

Taper is a 50ft min 100ft max

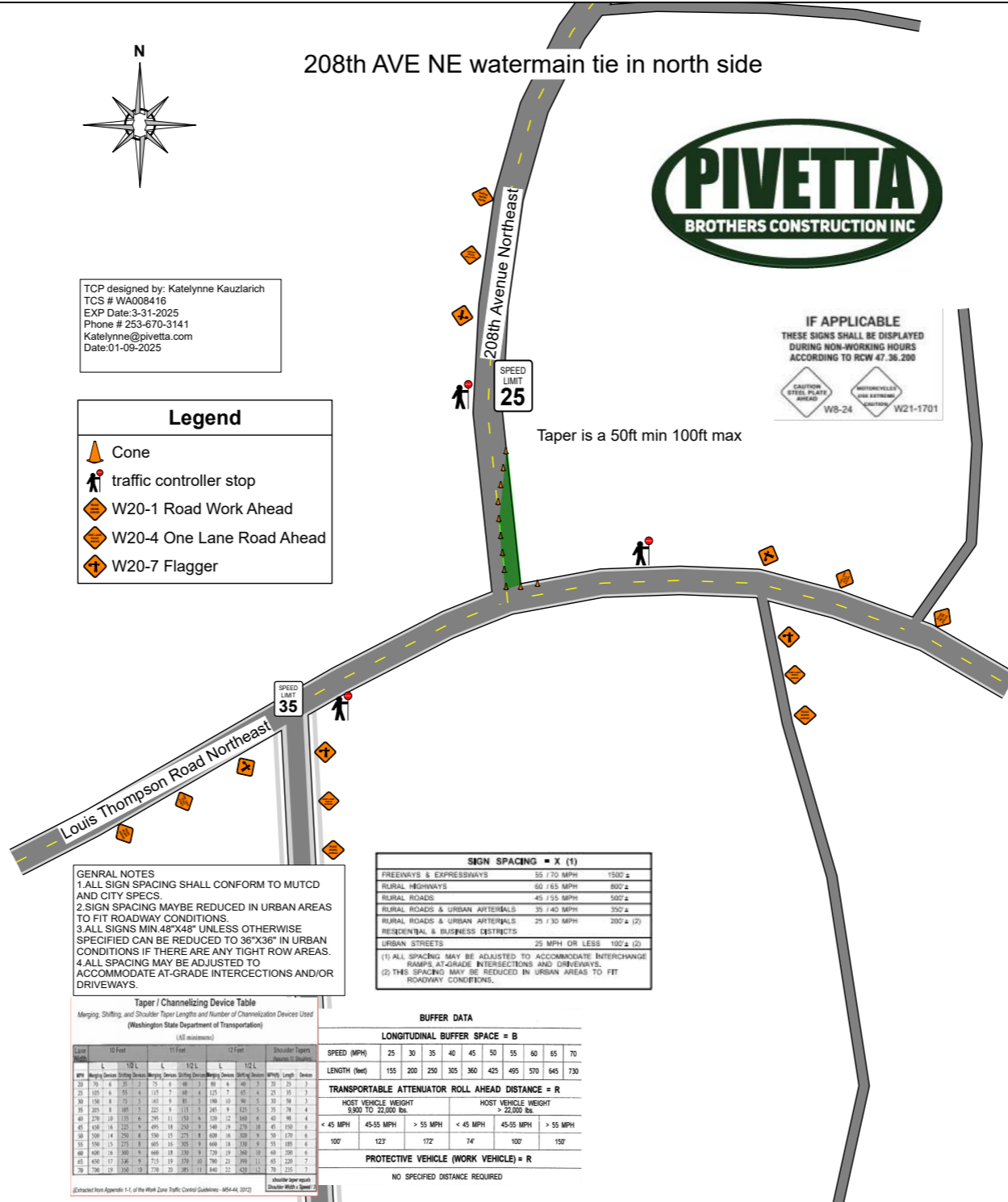

GENERAL NOTES

1. ALL SIGN SPACING SHALL CONFORM TO MUTCD AND CITY SPECS.
2. SIGN SPACING MAYBE REDUCED IN URBAN AREAS TO FIT ROADWAY CONDITIONS.
3. ALL SIGNS MIN 48"X48" UNLESS OTHERWISE SPECIFIED CAN BE REDUCED TO 36"X36" IN URBAN CONDITIONS IF THERE ARE ANY TIGHT ROW AREAS.
4. ALL SPACING MAY BE ADJUSTED TO ACCOMMODATE AT-GRADE INTERSECTIONS AND/OR DRIVEWAYS.

SIGN SPACING = X (1)

FREEDWAYS & EXPRESSWAYS	55 / 70 MPH	1500'±
RURAL HIGHWAYS	50 / 65 MPH	800'±
RURAL ROADS	45 / 55 MPH	500'±
RURAL ROADS & URBAN ARTERIALS	35 / 40 MPH	350'±
RURAL ROADS & URBAN ARTERIALS	25 / 30 MPH	200'± (2)
RESIDENTIAL & BUSINESS DISTRICTS		
URBAN STREETS	25 MPH OR LESS	100'± (2)

(1) ALL SPACING MAY BE ADJUSTED TO ACCOMMODATE INTERCHANGE RAMP AT-GRADE INTERSECTIONS AND DRIVEWAYS.
 (2) THIS SPACING MAY BE REDUCED IN URBAN AREAS TO FIT ROADWAY CONDITIONS.

Taper / Channelizing Device Table
 Merging, Shifting, and Shoulder Taper Lengths and Number of Channelizing Devices Used
 (Washington State Department of Transportation)
 (All minimums)

Lane Width	10 Feet			11 Feet			12 Feet			Shoulder Tapers Devices/1/2 Station
	L	1/2 L	L	L	1/2 L	L	1/2 L	L		
20'	75	37.5	75	60	30	60	45	22.5	45	
22'	82.5	41.25	82.5	66	33	66	49.5	24.75	49.5	
24'	90	45	90	72	36	72	54	27	54	
26'	97.5	48.75	97.5	78	39	78	58.5	29.25	58.5	
28'	105	52.5	105	84	42	84	63	31.5	63	
30'	112.5	56.25	112.5	90	45	90	67.5	33.75	67.5	
32'	120	60	120	96	48	96	72	36	72	
34'	127.5	63.75	127.5	102	51	102	76.5	38.25	76.5	
36'	135	67.5	135	108	54	108	81	40.5	81	
38'	142.5	71.25	142.5	114	57	114	85.5	42.75	85.5	
40'	150	75	150	120	60	120	90	45	90	
42'	157.5	78.75	157.5	126	63	126	94.5	47.25	94.5	
44'	165	82.5	165	132	66	132	99	49.5	99	
46'	172.5	86.25	172.5	138	69	138	103.5	51.75	103.5	
48'	180	90	180	144	72	144	108	54	108	
50'	187.5	93.75	187.5	150	75	150	112.5	56.25	112.5	
52'	195	97.5	195	156	78	156	117	58.5	117	
54'	202.5	101.25	202.5	162	81	162	121.5	60.75	121.5	
56'	210	105	210	168	84	168	126	63	126	
58'	217.5	108.75	217.5	174	87	174	130.5	65.25	130.5	
60'	225	112.5	225	180	90	180	135	67.5	135	
62'	232.5	116.25	232.5	186	93	186	139.5	69.75	139.5	
64'	240	120	240	192	96	192	144	72	144	
66'	247.5	123.75	247.5	198	99	198	148.5	74.25	148.5	
68'	255	127.5	255	204	102	204	153	76.5	153	
70'	262.5	131.25	262.5	210	105	210	157.5	78.75	157.5	

BUFFER DATA

LONGITUDINAL BUFFER SPACE = B

SPEED (MPH)	25	30	35	40	45	50	55	60	65	70
LENGTH (feet)	155	200	250	305	360	425	495	570	645	730

TRANSPORTABLE ATTENUATOR ROLL AHEAD DISTANCE = R

PROTECTIVE VEHICLE (WORK VEHICLE) = R	HOST VEHICLE WEIGHT 9,000 TO 22,000 lbs.		HOST VEHICLE WEIGHT > 22,000 lbs.	
	< 45 MPH	45-55 MPH	< 45 MPH	45-55 MPH
100'	123'	172'	74'	100'
150'				150'

NO SPECIFIED DISTANCE REQUIRED

(Extracted from Appendix 1-1 of the Work Zone Traffic Control Guidelines - 05/04/02)

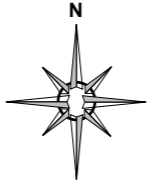

208th AVE NE watermain tie in South side



TCP designed by: Katelynne Kauzlarich
 TCS # WA008416
 EXP Date: 3-31-2025
 Phone # 253-670-3141
 Katelynne@pivetta.com
 Date: 01-09-2025

Legend

- Cone
- traffic controller stop
- W20-1 Road Work Ahead
- W20-4 One Lane Road Ahead
- W20-7 Flagger

IF APPLICABLE
 THESE SIGNS SHALL BE DISPLAYED
 DURING NON-WORKING HOURS
 ACCORDING TO RCW 47.36.200

W20-24 W21-1701

Target spacing is 25 ft on 208th
 Taper is a 50ft min 100ft max

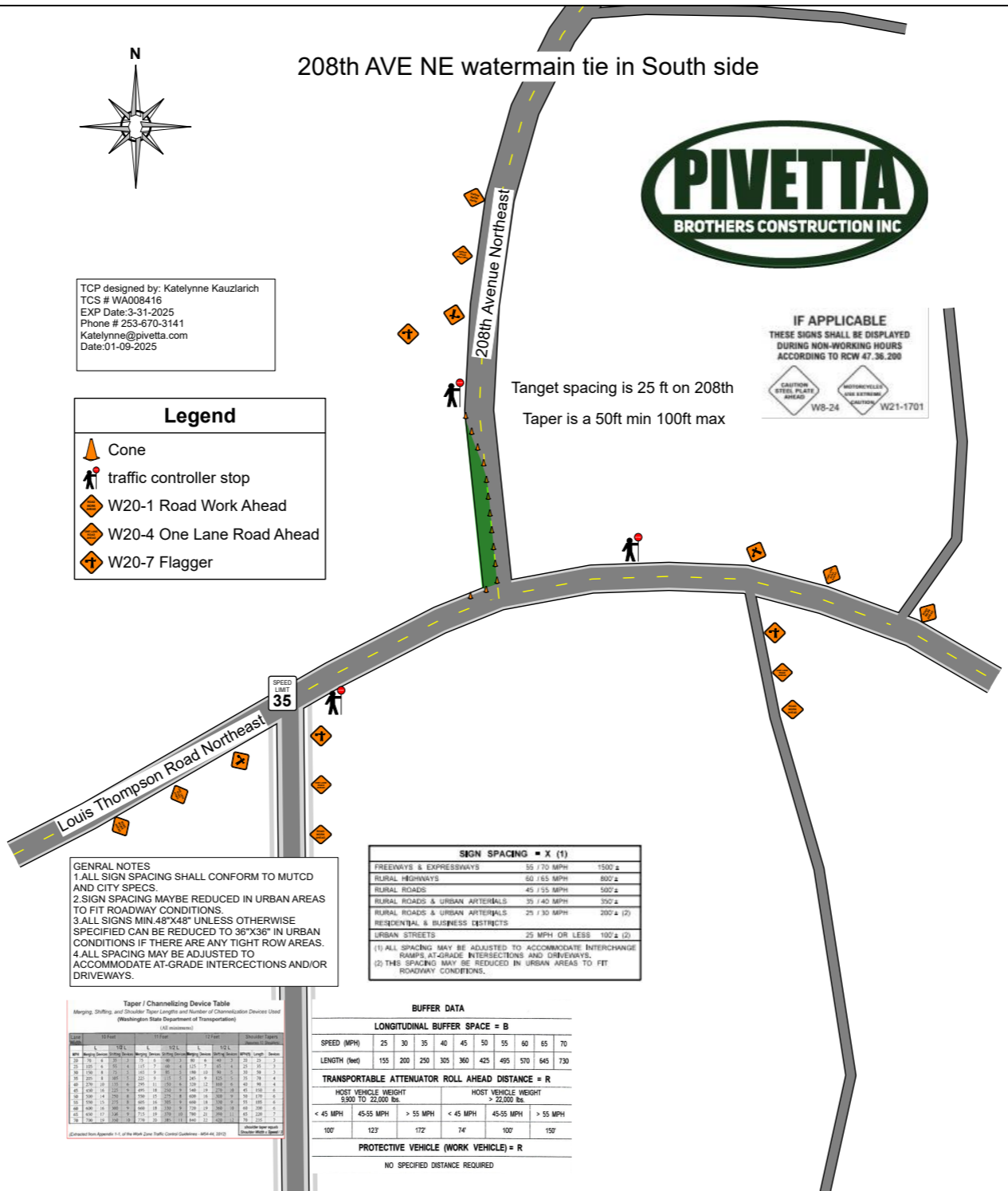

GENERAL NOTES
 1. ALL SIGN SPACING SHALL CONFORM TO MUTCD AND CITY SPECS.
 2. SIGN SPACING MAYBE REDUCED IN URBAN AREAS TO FIT ROADWAY CONDITIONS.
 3. ALL SIGNS MIN 48"X48" UNLESS OTHERWISE SPECIFIED CAN BE REDUCED TO 36"X36" IN URBAN CONDITIONS IF THERE ARE ANY TIGHT ROW AREAS.
 4. ALL SPACING MAY BE ADJUSTED TO ACCOMMODATE AT-GRADE INTERSECTIONS AND/OR DRIVEWAYS.

SIGN SPACING = X (1)

FREEWAYS & EXPRESSWAYS	55 / 70 MPH	1500' ±
RURAL HIGHWAYS	50 / 65 MPH	800' ±
RURAL ROADS	45 / 55 MPH	500' ±
RURAL ROADS & URBAN ARTERIALS	35 / 40 MPH	350' ±
RURAL ROADS & URBAN ARTERIALS	25 / 30 MPH	200' ± (2)
RESIDENTIAL & BUSINESS DISTRICTS		200' ± (2)
URBAN STREETS	25 MPH OR LESS	100' ± (2)

(1) ALL SPACING MAY BE ADJUSTED TO ACCOMMODATE INTERCHANGE RAMP AT-GRADE INTERSECTIONS AND DRIVEWAYS.
 (2) THIS SPACING MAY BE REDUCED IN URBAN AREAS TO FIT ROADWAY CONDITIONS.

Taper / Channelizing Device Table
 Merging, Shifting, and Shoulder Taper Lengths and Number of Channelizing Devices Used (Washington State Department of Transportation)
 (All dimensions in feet)

Lane	15 Feet		11 Feet		7.5 Feet		Shoulder Taper, Channelizing Devices
	L	S	L	S	L	S	
10'	10'	10'	10'	10'	10'	10'	10'
12'	12'	12'	12'	12'	12'	12'	12'
14'	14'	14'	14'	14'	14'	14'	14'
16'	16'	16'	16'	16'	16'	16'	16'
18'	18'	18'	18'	18'	18'	18'	18'
20'	20'	20'	20'	20'	20'	20'	20'
22'	22'	22'	22'	22'	22'	22'	22'
24'	24'	24'	24'	24'	24'	24'	24'
26'	26'	26'	26'	26'	26'	26'	26'
28'	28'	28'	28'	28'	28'	28'	28'
30'	30'	30'	30'	30'	30'	30'	30'
32'	32'	32'	32'	32'	32'	32'	32'
34'	34'	34'	34'	34'	34'	34'	34'
36'	36'	36'	36'	36'	36'	36'	36'
38'	38'	38'	38'	38'	38'	38'	38'
40'	40'	40'	40'	40'	40'	40'	40'
42'	42'	42'	42'	42'	42'	42'	42'
44'	44'	44'	44'	44'	44'	44'	44'
46'	46'	46'	46'	46'	46'	46'	46'
48'	48'	48'	48'	48'	48'	48'	48'
50'	50'	50'	50'	50'	50'	50'	50'
52'	52'	52'	52'	52'	52'	52'	52'
54'	54'	54'	54'	54'	54'	54'	54'
56'	56'	56'	56'	56'	56'	56'	56'
58'	58'	58'	58'	58'	58'	58'	58'
60'	60'	60'	60'	60'	60'	60'	60'
62'	62'	62'	62'	62'	62'	62'	62'
64'	64'	64'	64'	64'	64'	64'	64'
66'	66'	66'	66'	66'	66'	66'	66'
68'	68'	68'	68'	68'	68'	68'	68'
70'	70'	70'	70'	70'	70'	70'	70'

BUFFER DATA

LONGITUDINAL BUFFER SPACE = B

SPEED (MPH)	25	30	35	40	45	50	55	60	65	70
LENGTH (feet)	155	200	250	305	360	425	495	570	645	730

TRANSPORTABLE ATTENUATOR ROLL AHEAD DISTANCE = R

HOST VEHICLE WEIGHT 9,000 TO 22,000 lbs.		HOST VEHICLE WEIGHT > 22,000 lbs.	
< 45 MPH	45-55 MPH	< 45 MPH	> 55 MPH
100'	123'	172'	74'
100'	150'		

PROTECTIVE VEHICLE (WORK VEHICLE) = R

NO SPECIFIED DISTANCE REQUIRED